



CEMA B/C Rubber Disc Return Idlers

Rubber Disc Return Idlers are your solution to backside buildup on the return side of your conveyor. These rollers are designed to shed stuck on debris from the belt and keep your conveyor running true and clean.

■ Engineered Rubber Discs provide significant improvements in both material shedding and belt tracking.

■ Rubber Disc Spacers completely cover the empty space between discs to prevent disc walk in addition to providing exceptional corrosion resistance across the entire length of the roller.

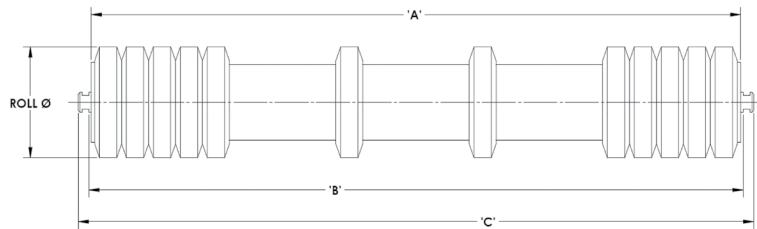
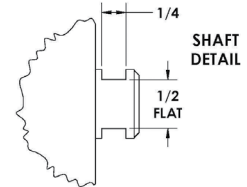

1. Aluminum Bearing Housing

for increased corrosion resistance

2. Internal Labyrinth Seal with contact lip

prevents contaminants from reaching bearings.

3. Proprietary Defender® Bearings

feature a proprietary seal design or superior contaminant resistance and grease retention.

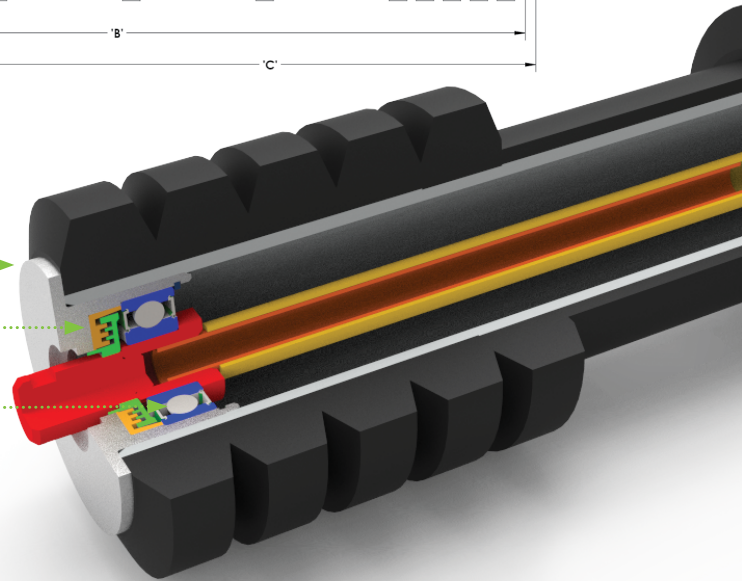

Rubber Disc Return Part Numbering

XX-XXX-XX

CEMA Series C (used for B & C Applications)

Belt Width 18-60"

Roll Diameter 4, 5

RRD - Rubber Disc Return roll

